



WATER & ELECTRICAL SYSTEM COMPARTMENT
 *Note-Equipment will vary based upon which EQUIPMENT GROUPS/ADDITIONS that are selected.

BUILT IN REFRIGERATION AREA (See Addition)
 Stainless steel refrigeration allows baristas easy drink preparation and storage of perishables.

BUILT IN CUP HOLDERS AREA (See Addition)
 Stainless steel cup holders allows baristas easy drink preparation.

STORAGE AREA WITH OPTIONAL SHELVING

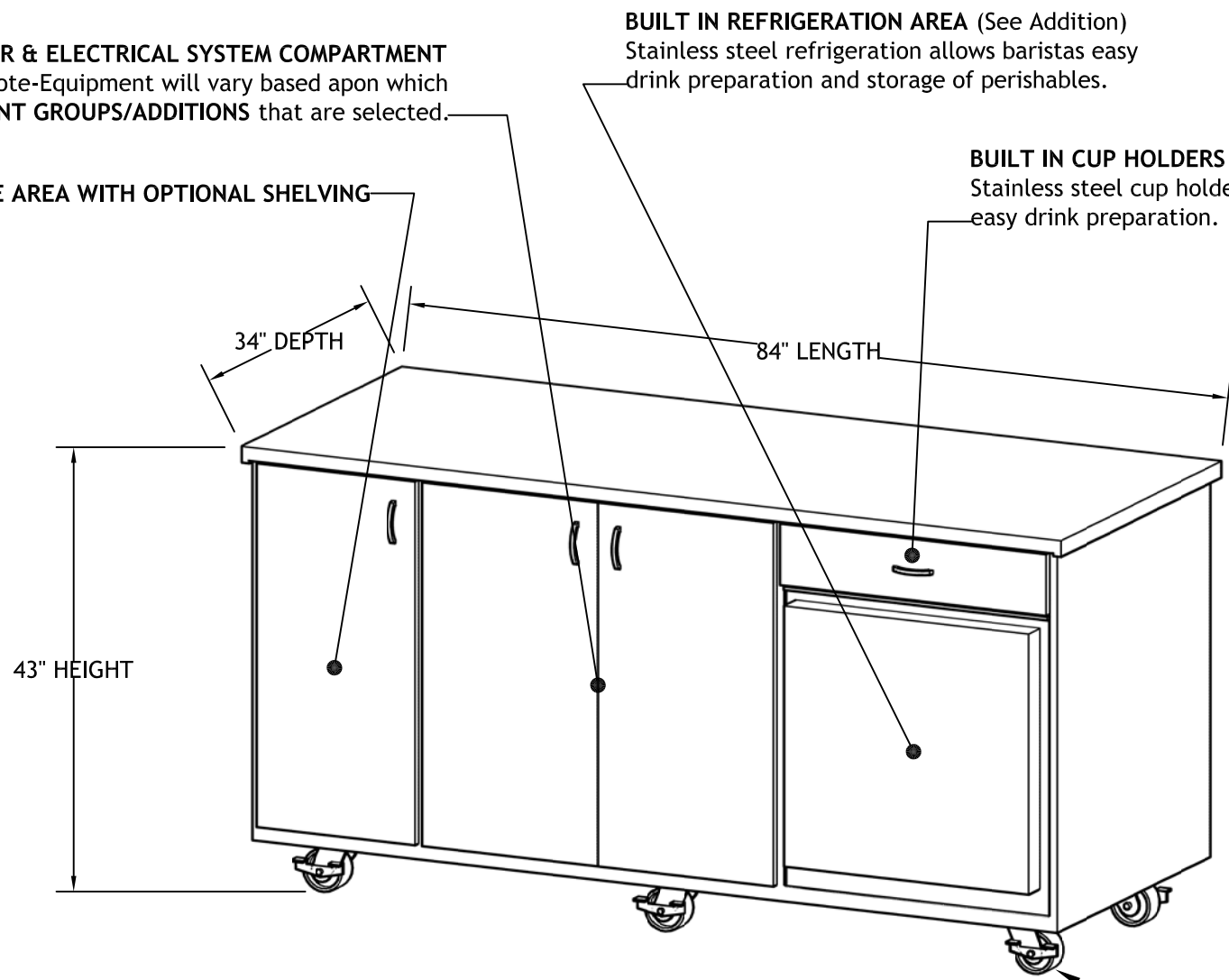

7 FOOT CART DESCRIPTON

CART CONSTRUCTION-The base frame of carts are fabricated with 3/4" thick marine grade plywood.

INTERIOR OF CART-Laminated with a white Formica.

EXTERIOR OF CART-Choice of Formica or Wilsonart laminates to match their location's theme and/or personal preference.

WHEELS-A total of six 5 1/2"x2" swivel casters with locking ability.

COUNTER TOPS-3/4" thick marine grade plywood with 1 1/2" overhang around entire exterior of cart. Formica or Wilsonart laminates on top.

*OPTIONAL-With 3" solid oak wood trim. (See Additions)

(6) 5 1/2" Tall Locking swivel wheels for easy transportation.